

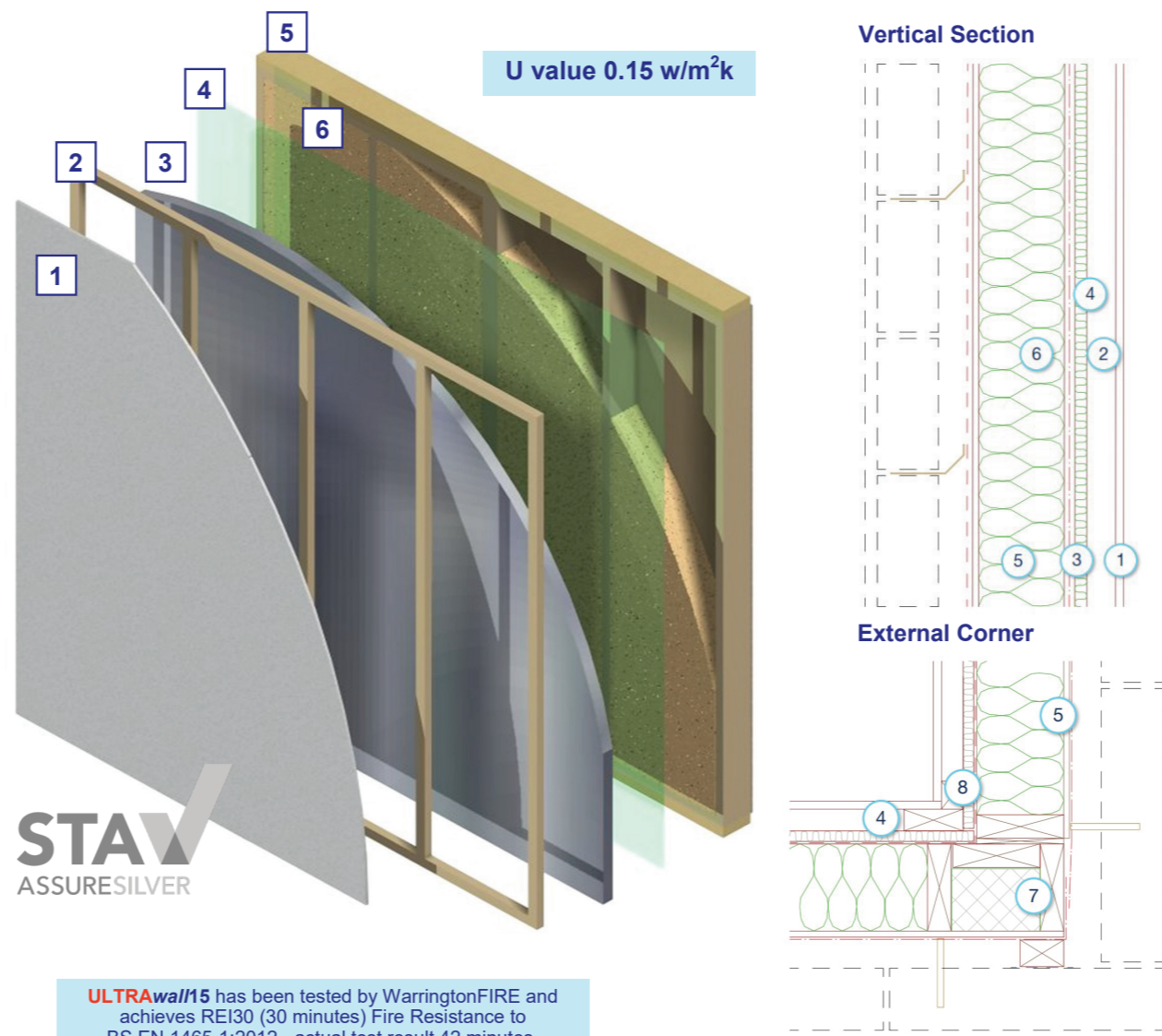

We look forward to helping you create your dream...



STAV
ASSURESILVER

ULTRAwal15 has been tested by WarringtonFIRE and achieves REI30 (30 minutes) Fire Resistance to BS EN 1465-1:2012 - actual test result 42 minutes.



Contact us:
Dalchonzie, By Comrie, Perthshire PH6 2LB
Tel: 01764 670424
Email: mail@robroyhomes.co.uk
Website: www.robroyhomes.co.uk
© All photographs & designs are copyright reserved by individual architects.

Rob Roy
HOMES

- Materials Legend**
- 1 - 15mm Knauf Wallboard plasterboard
 - 2 - 35mm deep x 45mm wide service void battens at 600mm cc
 - 3 - Urethane insulation board K value 0.022w/mk.
25mm thick : Overall wall U value 0.17w/m²k
40mm thick : Overall wall U value 0.15w/m²k
50mm thick : Overall wall U value 0.12w/m²k
 - * When using 184x38 studs at 600mmcc
 - 4 - Vapour control layer
 - 5 - External panel 140x38 studs at 600mm cc
 - 6 - Knauf Ecose Earthwool 140mm between studs
 - 7 - Factory fitted rigid corner insulation
 - 8 - 95x35 corner batten



Rob Roy
HOMES



INTRODUCTION...

Specialising in timber frame components for house builders and 'one off' individual customers. Rob Roy Homes is a timber frame company with a difference – we do not sell from a standard range of house designs because your building project is unique. Our experience and flexibility allows us to recommend the appropriate route for your individual project and your budget.

We recognise that each customer is different and has individual requirements. We consider all aspects of every project from the fundamentals of energy efficiency and sound reduction through to the final finishes. Our unique approach to timber frame construction, design and manufacture ensures that your project meets your expectations.

Spread throughout Scotland, Rob Roy Homes customers include large and small contractors building bungalows, one and a half, two and three-storey houses to multi-storey flats, commercial and agricultural structures. Though the majority of our business is individual one-off houses.

Whether you come to us with full architectural drawings, a basic sketch or just a vague idea at the back of your mind ...we can help you translate that into reality.

SPECIALISTS IN THE MANUFACTURE OF...
HIGH QUALITY TIMBER FRAME BUILDINGS

COMPANY INFO...

Rob Roy Homes specialise in timber frame structures, and pioneered large panel construction in Scotland. However, originally as builders, we experienced the strengths and weaknesses of various systems we were receiving from our timber frame suppliers and in the early Nineties, the company decided to supply individual self builders with a more flexible package tailored to suit specific needs and budget.

Today, Rob Roy Homes focus solely on the design and manufacture of timber frame buildings whilst offering value for money and excellent customer service.



Investment in premises

The company have a purpose built manufacturing facility next to our offices in rural Perthshire. We are continually up-dating our computer-aided design and manufacturing equipment to ensure maximum efficiency and accuracy with our designs and our end product.



What we offer...

You may come to us with completed architect's drawings, a rough sketch or just an idea which we can help develop. We can do as much or as little as you want. We can offer advice on how to find a plot of land, help identify a suitable architect and design for your site. If you require assistance with planning and building regulations, we have experienced personnel to help you. We will also offer advice on costings, material suppliers, tradesmen and insurance. On completion, your project will be independently assessed and certified by a firm of Civil and Structural Engineers.

Rob Roy
HOMES



You are invited to visit our offices at Dalchonzie, by Comrie, where you will see for yourself our approach to design, high standards and our desire to meet (and exceed) your expectations.

We are members of NHBC - National House Building Council which is the standard setting body and leading warranty provider for new and newly converted homes in the UK and STA – Structural Timber Frame Association, the trade association for UK timber frame manufacturers and the sector's key suppliers. TRADA Timber Research and Development Association have also approved several of our external wall type designs.

If this is your first foray into self build, we hope that our experience and enthusiasm will encourage you to join our many satisfied customers. However, please give some thought to the following points:-

- If you decide to embark on a self build project, be aware that the role of main contractor is a challenging task. If you would like to create your dream home without the associated headaches of organising the build, we can help identify an approved builder who will issue you with a fixed price for the contract and a warranty.
- Ensure your budget is realistic. Establish your costs completely and realistically before starting the project.



The company is continually updating their computer-aided design and manufacturing facilities.

Rob Roy Homes is a timber frame company with a difference - we do not sell from an existing range of houses.

Satisfied Customers:

'I would like to take the opportunity to thank you and your entire team for your involvement in the design and production of our wonderful holiday house. From our first meeting and throughout the project, your attention to detail and desire to create a truly unique, practical and stylish living space has resulted in a house far exceeding our most demanding plans.' Lawrence Ross, Oban

'We are absolutely delighted with our new cottage. Please pass on my thanks to the team for a job well done.' Mrs Eleanor Graham, Stirling

'Our project is on budget and completed in advance of our expectations and your company has played a big part in these efforts. Your company is to be commended for doing such a fine job and we particularly note that the material used throughout is of the highest quality' Mr & Mrs Hopkins, Lochearnhead, Perthshire

'Your unstinting generosity with your time, advice and guidance has been key to the success of our project - as well as the timber frame itself.' Roger Richard, Oban, Argyll

